

ITEM NO.	NAME	MATERIAL	QTY.
1	Seat_Assembly_240610-0	SEE SUB ASSEMBLY	1
2	Leg_Assembly_240610-0	SEE SUB ASSEMBLY	2
3	SCHCSCREW 0.375-16x3.25x1.25-HX-S	STAINLESS STEEL	2
4	Screw_Seat_240610-0	6061 ALLOY	4
5	Foot_Rest_Assembly_240610-0	SEE SUB ASSEMBLY	1
6	Backrest_Assembly_240610-0	SEE SUB ASSEMBLY	1
7	SBHCSCREW 0.375-16x0.75-HX-S	STAINLESS STEEL	4
8	SCHCSCREW 0.375-16x2.75x1.25-HX-S	STAINLESS STEEL	2
9	FLATCKT 0.25-14-type IA-AB-1.813-S	STAINLESS STEEL	12
10	SET SCREW	STAINLESS STEEL	2

# IMPORTANT INFORMATION!

## MUST READ BEFORE ASSEMBLY – NEW PARTS ATTACHED TO BOX

New set screws have been provided with all Stryker LP100 leaning posts. These set screws are used for securing the back rest clamps to a desired position. Attached to the outside of the shipping box is a packet with two **pointed tip set screws** that are to be used instead of the flat tip set screws currently installed in the clamps. **Please discard the incorrect flat tip set screws.** Refer to part #10 in the schematic below which can be downloaded from [strykertops.com/installation-guides](http://strykertops.com/installation-guides).



### NEW POINTED TIP SET SCREW

Use these two replacement screws during the installation.



### OLD FLAT TIP SET SCREW

**DO NOT USE!** Discard these two screws immediately.

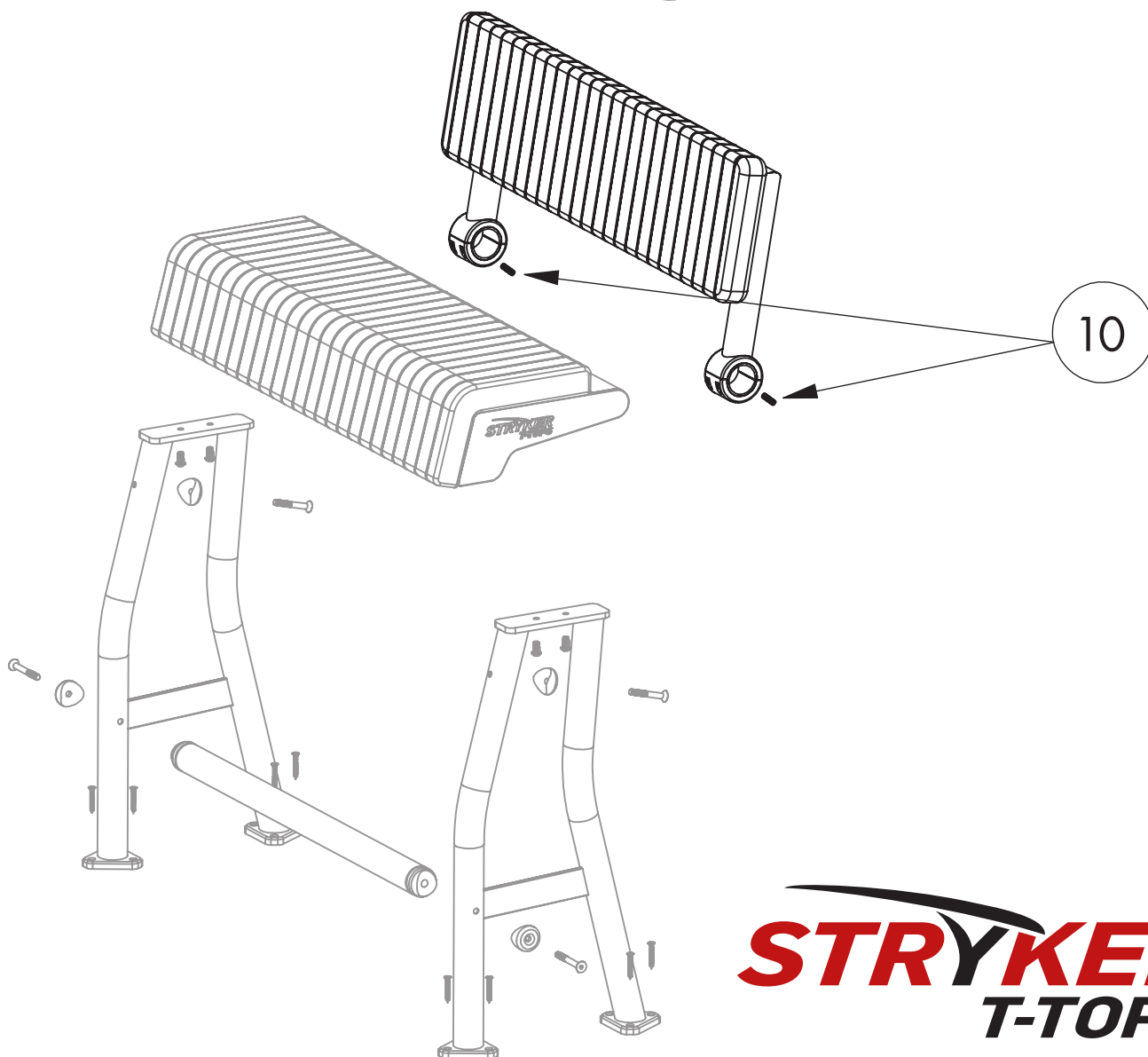

**STRYKER**  
T-TOPS